

Diamond Plates

A selection of four Diamond orientated Plates, all available in three sizes with a choice of five seating/collar options; and all designed to work in conjunction with the Door Levers & Door Knobs to be found in sections ST1 & ST2 (which can be attached to Face fixed Plates if desired).

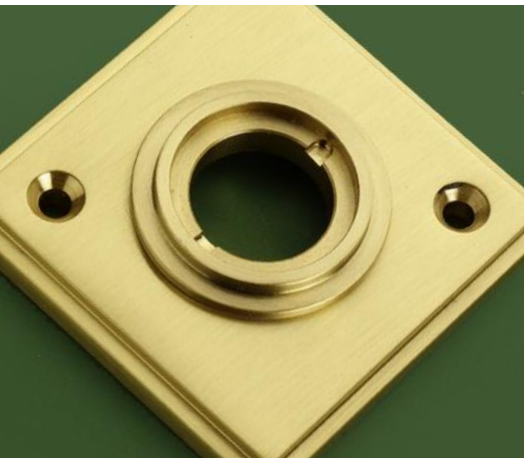

Fixings

Plate supplied with finish matched, no.6 x 19mm wood screws, alignment collar and installation instructions.

How to Order

Split Finish Sets - order as singles

Plates only:

- 1) select PLATE (e.g. **5951**)
 - 2) add SIZE (e.g. 5951**B**)
 - 3) add COLLAR DESIGN (e.g. 5951B/**K**)
 - 4) add FINISH (5951B/K/**PB**)
- For SINGLE PLATE add/H (e.g. 5951B/K/PB/**H**).

For FIX DEAD add FDS for pairs of plates (e.g. 5951B/K/PB/**FDS**) or FD for single plates (e.g. 5951B/K/PB/H/**FD**).

Plates with Levers/Knobs attached:

- 1) select PLATE (e.g. **4751**)
- 2) add SIZE (e.g. 4751**B**)
- 3) add COLLAR DESIGN (e.g. 4751B/**G**)
- 4) add FINISH (e.g. 4751B/G/**PB**)
- 5) add LEVER/KNOB from sections ST1 & ST2 (e.g. 4751B/G/PB/**7740**).

For SINGLE PLATE with LEVER add LH or RH (e.g. 4751B/G/PB/7740**LH**)

For SINGLE PLATE with KNOB add /H (e.g. 4751B/G/PB/7634B/**H**)

For FIX DEAD add FDS for pairs of plates (e.g. 4751B/G/PB/7634B/**FDS**) or FD for single plates (e.g.4751B/G/PB/7634B/H/**FD**).

Finishes - See our price list or website for finish availability.



size B shown with collar F

▲ **4751**



size B shown with collar J

▲ **4951**



size B shown with collar K

▲ **5951**



size B shown with collar L

▲ **6051** Size A available with type G flush seating only



4700 shown



4900 shown



5900 shown



6000 shown

Concealed fix diamond plates - order same as square plates, see page ST4:030

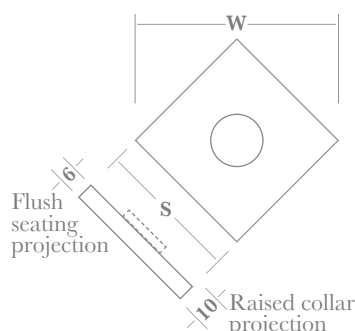

| | A | B | C |
|------------|----|----|----|
| S (square) | 44 | 54 | 64 |
| W (width) | 62 | 76 | 90 |

Custom sizes available upon request - surcharge may apply.

FIX DEAD DUMMY OPTION - FACE FIX ONLY (Supplied assembled)



Achieved by custom machining both the Plate & Lever/ Knob, then fixing together with a lockbolt.

Seating & Collar options



type G

type F

type J

type K

type L

See page ST6:010 for further details



Face Fix Plates can be supplied with Allart Select Levers or Knobs attached (circlip fixed) See sections ST1 & ST2

Square Rosettes - Face fixed



▲ 3250



▲ 3450

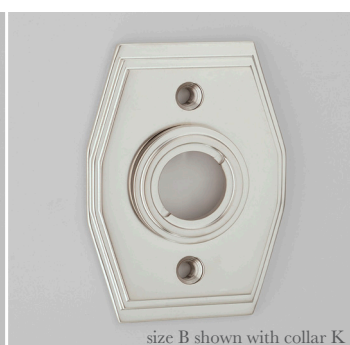

▲ 4150



▲ 4750

Face fixed Square Rosettes available in three sizes with a choice of seating/collar options, designed to work in conjunction with the Door Levers & Door Knobs to be found in sections ST1 & ST2 (which can be supplied attached if desired).

Fixings

Rosettes supplied with finish matched, no.6 x 19mm wood screws, alignment collars and installation instructions.

How to Order

Split Finish Sets -
order as singles

Rosettes only:

- 1) select ROSETTE (e.g. 4750)
- 2) add SIZE (e.g. 4750B)
- 3) add COLLAR DESIGN (e.g. 4750B/G)
- 4) add FINISH (4750B/G/PB).

For SINGLE ROSETTE add/H
(e.g. 4750B/G/PB/H).

For FIX DEAD add FDS for pairs of
rosettes (e.g. 4750B/G/PB/FDS) or FD for
single rosettes (e.g. 4750B/G/PB/H/FD).

Rosettes with Levers/Knobs attached;

- 1) select ROSETTE (e.g. 4750)
- 2) add SIZE (e.g. 4750B)
- 3) add COLLAR DESIGN (e.g. 4750B/G)
- 4) add FINISH (e.g. 4750B/G/PB)
- 5) add LEVER/KNOB from sections
ST1 & ST2 (e.g. 4750B/G/PB/7740).

For SINGLE PLATE with LEVER add
HANDING LH or RH
(e.g. 4750B/G/PB/7740LH)

For SINGLE ROSETTE with KNOB
add/H (e.g. 4750B/G/PB/7634B/H).

For FIX DEAD add FDS for pairs of
rosettes (e.g. 4750B/G/PB/7634B/FDS) or
FD for single rosettes
(e.g. 4750B/G/PB/7634B/H/FD).

Finishes - See our price list or
website for finish availability.



▲ 4850



▲ 4950



▲ 5150



▲ 5850

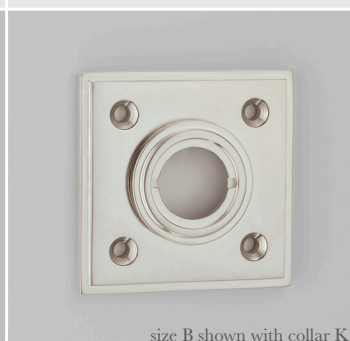

▲ 5950

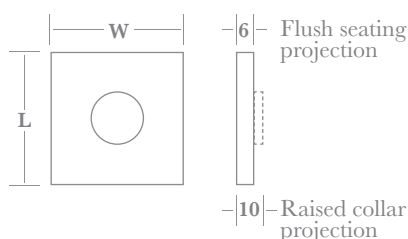
▲ 6050 Size A available with type G
flush seating only

| | A | B | C |
|------------------|---------|---------|---------|
| L x W | 44 x 44 | 54 x 54 | 64 x 64 |
| 3250, 3450, 4150 | 62 x 44 | 72 x 54 | 82 x 64 |

Custom sizes available upon request - surcharge may apply.

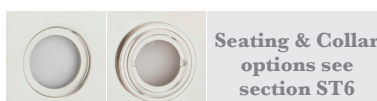

FIX DEAD DUMMY OPTION - (Supplied assembled)

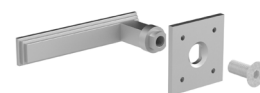

Achieved by custom machining
both the Rosette & Lever/Knob,
then fixing together with a lockbolt.

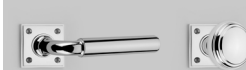

Face Fix Rosettes can be
supplied with Allart Select
Levers or Knobs attached
(circlip fixed)
See sections ST1 & ST2

Square Rosettes - Face fixed

Face fixed Square Rosettes available in three sizes with a choice of seating/collar options, designed to work in conjunction with the Door Levers & Door Knobs to be found in sections ST1 & ST2 (which can be supplied attached if desired).

Fixings

Rosettes supplied with finish matched, no.6 x 19mm wood screws, alignment collars and installation instructions.

How to Order

Split Finish Sets -
order as singles

Rosettes only:

- 1) select ROSETTE (e.g. **8450**)
- 2) add SIZE (e.g. 8450**B**)
- 3) add COLLAR DESIGN (e.g. 8450B/**G**)
- 4) add FINISH (8450B/G/**PB**).

For SINGLE PLATE add/H
(e.g. 8450B/G/PB/**H**).

For FIX DEAD add FDS for pairs of plates
(e.g. 8450B/G/PB/FDS) or FD for single
rosettes (e.g. 8450B/G/PB/H/**FD**).

Rosettes with Levers/Knobs attached;

- 1) select ROSETTE (e.g. **8450**)
- 2) add SIZE (e.g. 8450**B**)
- 3) add COLLAR DESIGN (e.g. 8450B/**G**)
- 4) add FINISH (e.g. 8450B/G/**PB**)
- 5) add LEVER/KNOB from sections
ST1 & ST2 (e.g. 8450B/G/PB/**7740**).

For SINGLE PLATE with LEVER add
HANDING LH or RH
(e.g. 8450B/G/PB/7740**LH**)

For SINGLE PLATE with KNOB add/H
(e.g. 8450B/G/PB/7634B/**H**).

For FIX DEAD add FDS for pairs of
rosettes (e.g. 8450B/G/PB/7634B/FDS) or
FD for single rosettes
(e.g. 8450B/G/PB/7634B/H/**FD**).

Finishes - See our price list or
website for finish availability.

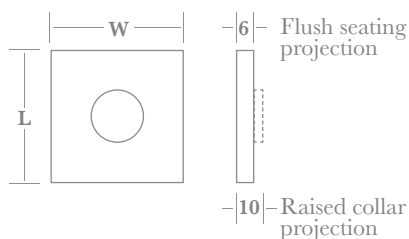

| | A | B | C |
|-------|---------|---------|---------|
| L x W | 44 x 44 | 54 x 54 | 64 x 64 |

Custom sizes available upon request - surcharge may apply.

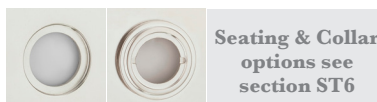

FIX DEAD DUMMY OPTION - (Supplied assembled)



Achieved by custom machining
both the Rosette & Lever/Knob,
then fixing together with a lockbolt.

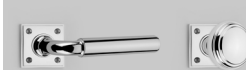

Face Fix Rosettes can be
supplied with Allart Select
Levers or Knobs attached
(circlip fixed)
See sections ST1 & ST2

Square Rosettes - Concealed fix



▲ 3200



▲ 3400



▲ 4100



▲ 4700

Concealed fix Square Rosettes available in three sizes with a choice of collar options, designed to work in conjunction with the Door Levers & Door Knobs to be found in sections ST1 & ST2.

NB. Please note Levers & Knobs cannot be attached to Concealed fix Rosettes.

Fixings

Supplied with subroses, no.4 x 13mm wood screws, alignment collars and installation instructions.

Fix Dead Rosettes are supplied with 7813 mounts in place of standard subroses (*).

Pair of Pre-Bore Rosettes (sizes C only) supplied with 7800 Pre-Bore Adaptor in place of standard Rosettes (*).

(*) See pages ST6:070 & 080 for details.

How to Order

Split Finish Sets -
order as singles

- 1) select PLATE (e.g. **4700**)
- 2) add SIZE (e.g. 4700**B**)
- 3) add COLLAR DESIGN (e.g. 4700B/**F**)
- 4) add FINISH (4700B/F/**PB**).

For SINGLE PLATE add/H
(e.g. 4700B/F/PB/**H**).

For FIX DEAD pair of rosettes add FDS
(e.g. 4700B/F/PB/**FDS**).

For FIX DEAD single plate add FD
(e.g. 4700B/F/PB/H/**FD**).

For pair of rosettes with PRE-BORE ADAPTOR (sizes C only) add PRE
(e.g. 4700C/F/PB/**PRE**).

Finishes - See our price list or website for finish availability.



▲ 4800



▲ 4900



▲ 5100



▲ 5800



▲ 5900



▲ 6000

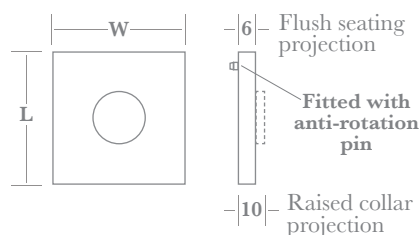

| | A | B | C |
|------------------|---------|---------|---------|
| L x W | 44 x 44 | 54 x 54 | 64 x 64 |
| 3200, 3400, 4100 | 62 x 44 | 72 x 54 | 82 x 64 |

Custom sizes available upon request - surcharge may apply.

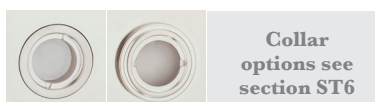

Square Rosettes - Concealed fix

Concealed fix Square Rosettes available in three sizes with a choice of collar options, designed to work in conjunction with the Door Levers & Door Knobs to be found in sections ST1 & ST2.

NB. Please note Levers & Knobs cannot be attached to Concealed fix Rosettes.

Fixings

Supplied with subroses, no.4 x 13mm wood screws, alignment collars and installation instructions.

Fix Dead Rosettes are supplied with 7813 mounts in place of standard subroses (*).

Pair of Pre-Bore Rosettes (sizes C only) supplied with 7800 Pre-Bore Adaptor in place of standard Rosettes (*).

(*) See pages ST6:070 & 080 for details.

How to Order

- 1) select ROSETTE (e.g. **6600**)
- 2) add SIZE (e.g. 6600**B**)
- 3) add COLLAR DESIGN (e.g. 6600B/**K**)
- 4) add FINISH (6600B/K/**PB**).

For SINGLE PLATE add/H (e.g. 6600B/K/PB/**H**).

For FIX DEAD pair of rosettes add FDS (e.g. 6600B/K/PB/H/**FDS**).

For FIX DEAD single plate add FD (e.g. 6600B/K/PB/H/**FD**).

For pair of rosettes with PRE-BORE ADAPTOR (sizes C only) add PRE (e.g. 6600C/K/PB/**PRE**).

Finishes - See our price list or website for finish availability.

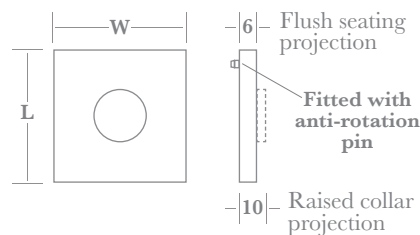

| | A | B | C |
|-------|---------|---------|---------|
| L x W | 44 x 44 | 54 x 54 | 64 x 64 |

Custom sizes available upon request - surcharge may apply.

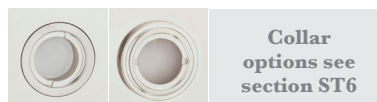

Backplate - 32 series

An Art Deco inspired, contemporary Backplate, offered with a selection of collar designs and available either face fixed or concealed fix.

This Backplate is designed to work in conjunction with the Door Levers & Door Knobs to be found in sections ST1 & ST2.



Standard Sizes

| Length | 190 | 254 | 305 | 380 |
|--------|-----|-----|-----|-----|
|--------|-----|-----|-----|-----|

| Width | Availability |
|-------|---|
| 27 | Not Available. |
| 32 | |
| 38 | All Configurations & Options, <u>except</u> US Entry. |
| 44 | All Configurations & Options. |
| 54 | |
| 64 | |
| 76 | |

| Thickness |
|--|
| 6mm for all unsprung backplates. 9mm for all spring-assisted* backplates. |

*Spring-assisted backplates need to be 9mm thick to accommodate the spring cassette, and require a raised collar; G flush collar/seating option not possible.

Finishes - See our price list or website for finish availability.



3211 190mm x 44mm latch plate shown with collar K

▲ **Latch (Passage), Lock & Privacy Configuration** - see pages ST5:010-080



▲ **Collar, Turn & Privacy Release Options** - see section ST6

| | |
|-------------------|-----------------|
| 54mm wide shown | 38mm wide shown |
| | |
| 44mm wide & above | 38mm wide only |

▲ **Face Fixed screw positions**



254mm x 38mm shown with turn T56

▲ **Multipoint Configuration** - see pages ST5:150-200



254mm x 54mm shown with turn T56, collar K and C01 exposed cylinder option.

▲ **US Entry Configuration** - see pages ST5:090-140

Backplate - 34 series

A traditional period Backplate, offered with a selection of collar designs and available either face fixed or concealed fix.

This Backplate is designed to work in conjunction with the Door Levers & Door Knobs to be found in sections ST1 & ST2.



Standard Sizes

| Length | 190 | 254 | 305 | 380 |
|--------|-----|-----|-----|-----|
|--------|-----|-----|-----|-----|

| Width | Availability |
|-------|--|
| 27 | Not Available. |
| 32 | |
| 38 | All Face Fix Configurations with type G seating only, <u>except</u> US Entry & Spring Assisted Multipoint. |
| 44 | All Configurations and Options <u>except</u> US Entry. |
| 54 | All Configurations & Options. |
| 64 | |
| 76 | |

Thickness

6mm for all unsprung backplates.
9mm for all spring-assisted* backplates.

*Spring-assisted backplates need to be 9mm thick to accommodate the spring cassette, and require a raised collar; G flush collar/seating option not possible.

Finishes - See our price list or website for finish availability.



3411 190mm x 44mm latch plate shown with collar L

▲ **Latch (Passage), Lock & Privacy Configuration** - see pages ST5:010-080



▲ **Collar, Turn & Privacy Release Options** - see section ST6

54mm wide shown



44mm wide & above

38mm wide shown



38mm wide only

▲ **Face Fixed screw positions**



254mm x 38mm shown with turn T78

▲ **Multipoint Configuration** - see pages ST5:150-200



254mm x 54mm shown with turn T78, collar L and C01 exposed cylinder option.

▲ **US Entry Configuration** - see pages ST5:090-140

Backplate - 41 series

A classic Art Deco period Backplate, offered with a selection of collar designs and available either face fixed or concealed fix.

This Backplate is designed to work in conjunction with the Door Levers & Door Knobs to be found in sections ST1 & ST2.



Standard Sizes

| Length | 190 | 254 | 305 | 380 |
|--|--|-----|-----|-----|
| Width | Availability | | | |
| 27 | Not Available. | | | |
| 32 | | | | |
| 38 | All Face Fix Configurations with type G seating only, <u>except</u> US Entry & Spring Assisted Multipoint. | | | |
| 44 | All Configurations and Options <u>except</u> US Entry. | | | |
| 54 | All Configurations & Options. | | | |
| 64 | | | | |
| 76 | | | | |
| Thickness | | | | |
| 6mm for all unsprung backplates. 9mm for all spring-assisted* backplates. | | | | |

*Spring-assisted backplates need to be 9mm thick to accommodate the spring cassette, and require a raised collar; G flush collar/seating option not possible.

Finishes - See our price list or website for finish availability.



4111 190mm x 44mm latch plate shown with collar K

▲ **Latch (Passage), Lock & Privacy Configuration** - see pages ST5:010-080

▲ **Collar, Turn & Privacy Release Options** - see section ST6

54mm wide shown

38mm wide shown

44mm wide & above

38mm wide only

▲ **Face Fixed screw positions**

254mm x 38mm shown with turn T54

▲ **Multipoint Configuration** - see pages ST5:150-200

254mm x 54mm shown with turn T54, collar K and C01 exposed cylinder option.

▲ **US Entry Configuration** - see pages ST5:090-140

Backplate - 47 series

A classic bevelled edged Backplate, offered with a selection of collar designs and available either face fixed or concealed fix. This Backplate is designed to work in conjunction with the Door Levers & Door Knobs to be found in sections ST1 & ST2.



Standard Sizes

| Length | 190 | 254 | 305 | 380 |
|--------|-----|-----|-----|-----|
|--------|-----|-----|-----|-----|

| Width | Availability |
|-------|---|
| 27 | Not Available. |
| 32 | Unsprung Multipoint with type G seating only. |
| 38 | All Configurations & Options, <u>except</u> US Entry. |
| 44 | All Configurations & Options. |
| 54 | |
| 64 | |
| 76 | |

| Thickness |
|--|
| 6mm for all unsprung backplates. 9mm for all spring-assisted* backplates. |

*Spring-assisted backplates need to be 9mm thick to accommodate the spring cassette, and require a raised collar; G flush collar/seating option not possible.

Finishes - See our price list or website for finish availability.



4711 190mm x 44mm latch plate shown with collar F

▲ **Latch (Passage), Lock & Privacy Configuration - see pages ST5:010-080**



▲ **Collar, Turn & Privacy Release Options - see section ST6**

54mm wide shown



38mm wide shown



44mm wide & above



32mm & 38mm wide



▲ **Face Fixed screw positions**



254mm x 38mm shown with turn T58

▲ **Multipoint Configuration - see pages ST5:150-200**



254mm x 54mm shown with turn T58, collar F and C01 exposed cylinder option.

▲ **US Entry Configuration - see pages ST5:090-140**

Backplate - 48 series

A modern Backplate, offered with a selection of collar designs and available either face fixed or concealed fix.

This Backplate is designed to work in conjunction with the Door Levers & Door Knobs to be found in sections ST1 & ST2.



Standard Sizes

| Length | 190 | 254 | 305 | 380 |
|--------|---|-----|-----|-----|
| Width | Availability | | | |
| 27 | Not Available. | | | |
| 32 | | | | |
| 38 | All Configurations & Options, <u>except</u> US Entry. | | | |
| 44 | All Configurations & Options. | | | |
| 54 | | | | |
| 64 | | | | |
| 76 | | | | |

Thickness

6mm for all unsprung backplates.
9mm for all spring-assisted* backplates.

*Spring-assisted backplates need to be 9mm thick to accommodate the spring cassette, and require a raised collar; G flush collar/seating option not possible.

Finishes - See our price list or website for finish availability.



4817 190mm x 44mm privacy plate shown with collar G

▲ **Latch (Passage), Lock & Privacy Configuration** - see pages ST5:010-080

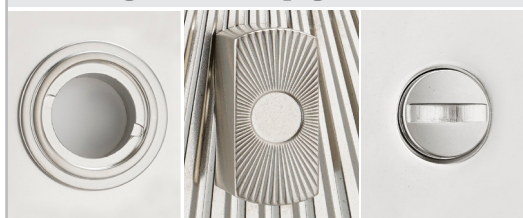

▲ **Collar, Turn & Privacy Release Options** - see section ST6

54mm wide shown



44mm wide & above

38mm wide shown

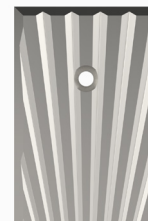

38mm wide only

▲ **Face Fixed screw positions**

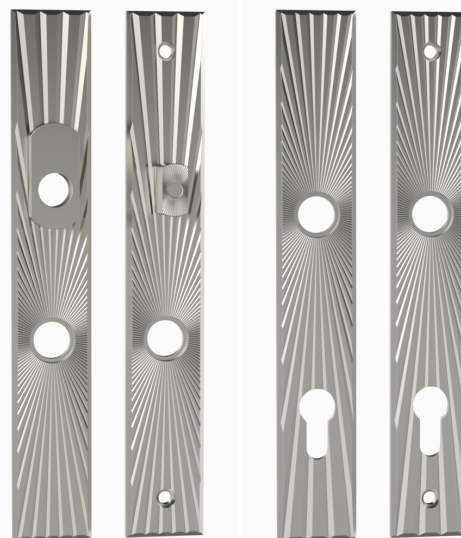

254mm x 38mm shown with turn T48

▲ **Multipoint Configuration** - see pages ST5:150-200

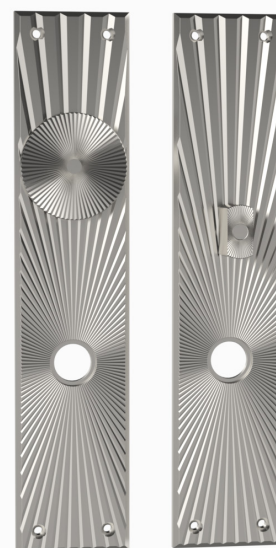

254mm x 54mm shown with turn T48, G seat and C18 cylinder cover.

▲ **US Entry Configuration** - see pages ST5:090-140

Backplate - 49 series

A classic square edged Backplate, offered with a selection of collar designs and available either face fixed or concealed fix.

This Backplate is designed to work in conjunction with the Door Levers & Door Knobs to be found in sections ST1 & ST2.



Standard Sizes

| Length | 190 | 254 | 305 | 380 |
|--------|-----|-----|-----|-----|
|--------|-----|-----|-----|-----|

| Width | Availability |
|-------|---|
| 27 | Unsprung Multipoint with type G seating only. |
| 32 | |
| 38 | All Configurations & Options, <u>except</u> US Entry. |
| 44 | All Configurations & Options. |
| 54 | |
| 64 | |
| 76 | |

| Thickness |
|--|
| 6mm for all unsprung backplates. |
| 9mm for all spring-assisted* backplates. |

*Spring-assisted backplates need to be 9mm thick to accommodate the spring cassette, and require a raised collar; G flush collar/seating option not possible.

Finishes - See our price list or website for finish availability.



4911 190mm x 44mm latch plate shown with collar J

▲ **Latch (Passage), Lock & Privacy Configuration** - see pages ST5:010-080



▲ **Collar, Turn & Privacy Release Options** - see section ST6

54mm wide shown

38mm wide shown

44mm wide & above

27, 32 & 38mm wide

▲ **Face Fixed screw positions**



254mm x 38mm shown with turn T63

▲ **Multipoint Configuration** - see pages ST5:150-200



254mm x 54mm shown with turn T63, collar J and CO4 cylinder cover

▲ **US Entry Configuration** - see pages ST5:090-140

Backplate - 51 series

A modern Backplate, offered with a selection of collar designs and available either face fixed or concealed fix.

This Backplate is designed to work in conjunction with the Door Levers & Door Knobs to be found in sections ST1 & ST2.



Standard Sizes

| Length | 190 | 254 | 305 | 380 |
|--|---|-----|-----|-----|
| Width | Availability | | | |
| 27 | Not Available. | | | |
| 32 | | | | |
| 38 | All Configurations & Options, <u>except</u> US Entry. | | | |
| 44 | All Configurations & Options. | | | |
| 54 | | | | |
| 64 | | | | |
| 76 | | | | |
| Thickness | | | | |
| 6mm for all unsprung backplates. 9mm for all spring-assisted* backplates. | | | | |

*Spring-assisted backplates need to be 9mm thick to accommodate the spring cassette, and require a raised collar; G flush collar/seating option not possible.

Finishes - See our price list or website for finish availability.



5117 190mm x 44mm privacy plate shown with collar G

▲ **Latch (Passage), Lock & Privacy Configuration** - see pages ST5:010-080

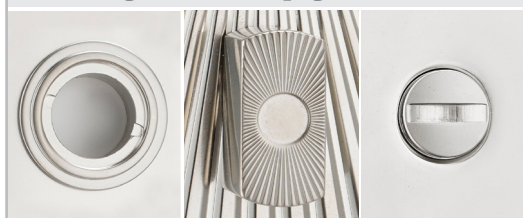

▲ **Collar, Turn & Privacy Release Options** - see section ST6

54mm wide shown



44mm wide & above

38mm wide shown

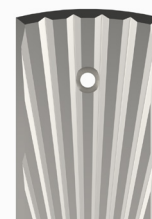

38mm wide only

▲ **Face Fixed screw positions**

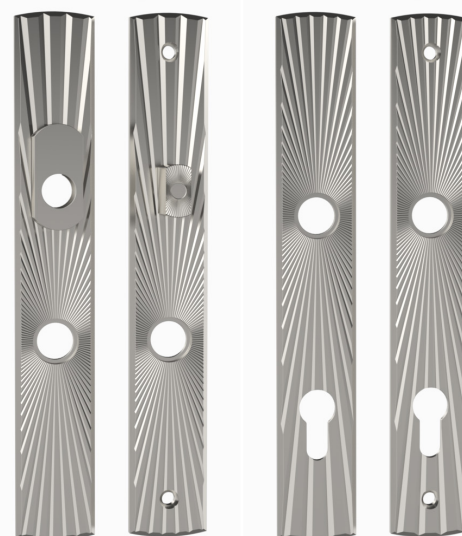

254mm x 38mm shown with turn T48

▲ **Multipoint Configuration** - see pages ST5:150-200

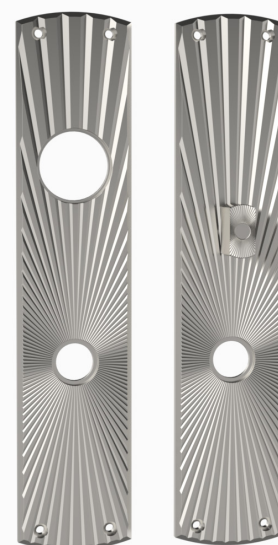

254mm x 54mm shown with turn T48, G seat and C01 exposed cylinder option.

▲ **US Entry Configuration** - see pages ST5:090-140

Backplate - 58 series

A classic stepped edge Backplate, offered with a selection of collar designs and available either face fixed or concealed fix.

This Backplate is designed to work in conjunction with the Door Levers & Door Knobs to be found in sections ST1 & ST2.

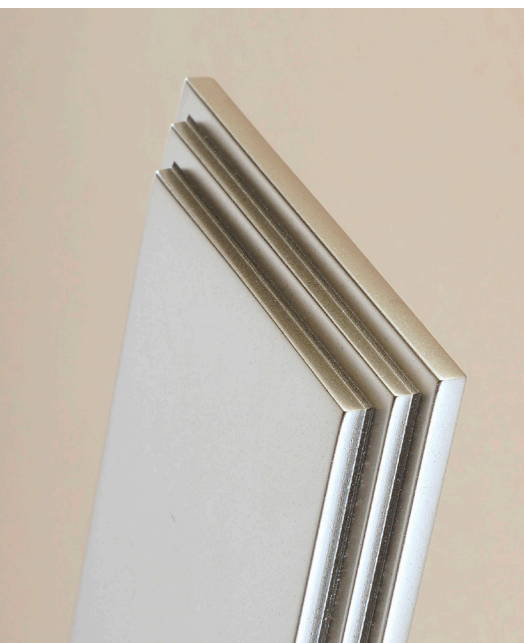

Standard Sizes

| Length | 190 | 254 | 305 | 380 |
|--------|-----|-----|-----|-----|
|--------|-----|-----|-----|-----|

| Width | Availability |
|-------|--|
| 27 | Not Available. |
| 32 | |
| 38 | All Face Fix Configurations with type G seating only, <u>except</u> US Entry & Spring Assisted Multipoint. |
| 44 | All Configurations and Options <u>except</u> US Entry. |
| 54 | All Configurations & Options. |
| 64 | |
| 76 | |

Thickness

6mm for all unsprung backplates.
9mm for all spring-assisted* backplates.

*Spring-assisted backplates need to be 9mm thick to accommodate the spring cassette, and require a raised collar; G flush collar/seating option not possible.

Finishes - See our price list or website for finish availability.



5811 190mm x 44mm latch plate shown with collar K

▲ **Latch (Passage), Lock & Privacy Configuration** - see pages ST5:010-080



▲ **Collar, Turn & Privacy Release Options** - see section ST6

54mm wide shown



44mm wide & above

38mm wide shown



38mm wide only

▲ **Face Fixed screw positions**



254mm x 38mm shown with turn T86

▲ **Multipoint Configuration** - see pages ST5:150-200



254mm x 54mm shown with turn T86, collar K and C01 exposed cylinder option.

▲ **US Entry Configuration** - see pages ST5:090-140

Backplate - 59 series

A classic stepped edge Backplate, offered with a selection of collar designs and available either face fixed or concealed fix.

This Backplate is designed to work in conjunction with the Door Levers & Door Knobs to be found in sections ST1 & ST2.



Standard Sizes

| Length | 190 | 254 | 305 | 380 |
|--------|---|-----|-----|-----|
| Width | Availability | | | |
| 27 | Not available. | | | |
| 32 | Unsprung Multipoint with type G seating only. | | | |
| 38 | All Configurations & Options, <u>except</u> US Entry. | | | |
| 44 | All Configurations & Options. | | | |
| 54 | | | | |
| 64 | | | | |
| 76 | | | | |

Thickness

6mm for all unsprung backplates.
9mm for all spring-assisted* backplates.

*Spring-assisted backplates need to be 9mm thick to accommodate the spring cassette, and require a raised collar; G flush collar/seating option not possible.

Finishes - See our price list or website for finish availability.



5911 190mm x 44mm latch plate shown with collar K

▲ **Latch (Passage), Lock & Privacy Configuration** - see pages ST5:010-080

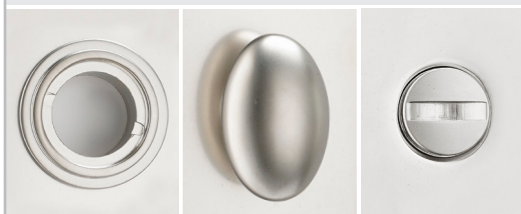

▲ **Collar, Turn & Privacy Release Options** - see section ST6

54mm wide shown

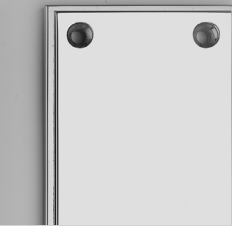

44mm wide & above

38mm wide shown



32mm & 38mm wide

▲ **Face Fixed screw positions**



254mm x 38mm shown with turn T51

▲ **Multipoint Configuration** - see pages ST5:150-200



254mm x 54mm shown with turn T61, collar K and C01 exposed cylinder option.

▲ **US Entry Configuration** - see pages ST5:090-140

Backplate - 60 series

A traditional period Backplate, offered with a selection of collar designs and available either face fixed or concealed fix.

This Backplate is designed to work in conjunction with the Door Levers & Door Knobs to be found in sections ST1 & ST2.



Standard Sizes

| Length | 190 | 254 | 305 | 380 |
|--------|--|-----|-----|-----|
| Width | Availability | | | |
| 27 | Not Available. | | | |
| 32 | | | | |
| 38 | All Face Fix Configurations with type G seating only, <u>except</u> US Entry & Spring Assisted Multipoint. | | | |
| 44 | All Configurations and Options <u>except</u> US Entry. | | | |
| 54 | All Configurations & Options. | | | |
| 64 | | | | |
| 76 | | | | |

Thickness

6mm for all unsprung backplates.
9mm for all spring-assisted* backplates.

*Spring-assisted backplates need to be 9mm thick to accommodate the spring cassette, and require a raised collar; G flush collar/seating option not possible.

Finishes - See our price list or website for finish availability.



6011 190mm x 44mm latch plate shown with collar L

▲ **Latch (Passage), Lock & Privacy Configuration** - see pages ST5:010-080



▲ **Collar, Turn & Privacy Release Options** - see section ST6

54mm wide shown



44mm wide & above

38mm wide shown



38mm wide only

▲ **Face Fixed screw positions**



254mm x 38mm shown with turn T51

▲ **Multipoint Configuration** - see pages ST5:150-200



254mm x 54mm shown with turn T51, collar L and C01 exposed cylinder option.

▲ **US Entry Configuration** - see pages ST5:090-140

Backplate - 66 series

A classic Art Deco period Backplate, offered with a selection of collar designs and available either face fixed or concealed fix.

This Backplate is designed to work in conjunction with the Door Levers & Door Knobs to be found in sections ST1 & ST2.



Standard Sizes

| Length | 190 | 254 | 305 | 380 |
|--------|-----|-----|-----|-----|
|--------|-----|-----|-----|-----|

| Width | Availability |
|-------|---|
| 27 | Not Available. |
| 32 | |
| 38 | All Configurations & Options, <u>except</u> US Entry. |
| 44 | All Configurations & Options. |
| 54 | |
| 64 | |
| 76 | |

| Thickness |
|--|
| 6mm for all unsprung backplates. 9mm for all spring-assisted* backplates. |

*Spring-assisted backplates need to be 9mm thick to accommodate the spring cassette, and require a raised collar; G flush collar/seating option not possible.

Finishes - See our price list or website for finish availability.



6611 190mm x 54mm latch plate shown with collar K

▲ **Latch (Passage), Lock & Privacy Configuration** - see pages ST5:010-080



▲ **Collar, Turn & Privacy Release Options** - see section ST6

54mm wide shown

38mm wide shown

44mm wide & above

38mm wide only

▲ **Face Fixed screw positions**



254mm x 38mm shown with turn T54

▲ **Multipoint Configuration** - see pages ST5:150-200



254mm x 54mm shown with turn T54, G seat and C01 exposed cylinder option.

▲ **US Entry Configuration** - see pages ST5:090-140

Backplate - 67 series (square edge design)

A classic Art Deco period Backplate, offered with a selection of collar designs and available either face fixed or concealed fix.

This Backplate is designed to work in conjunction with the Door Levers & Door Knobs to be found in sections ST1 & ST2.



Standard Sizes

| Length | 190 | 254 | 305 | 380 |
|--------|-----|-----|-----|-----|
|--------|-----|-----|-----|-----|

| Width | Availability |
|-------|--|
| 27 | Not Available. |
| 32 | |
| 38 | All Face Fix Configurations with type G seating only, <u>except</u> US Entry & Spring Assisted Multipoint. |
| 44 | All Configurations and Options <u>except</u> US Entry. |
| 54 | All Configurations & Options. |
| 64 | |
| 76 | |

Thickness

6mm for all unsprung backplates.
9mm for all spring-assisted* backplates.

*Spring-assisted backplates need to be 9mm thick to accommodate the spring cassette, and require a raised collar; G flush collar/seating option not possible.

Finishes - See our price list or website for finish availability.



6711 190mm x 44mm latch plate shown with collar G

▲ Latch (Passage), Lock & Privacy Configuration - see pages ST5:010-080



▲ Collar, Turn & Privacy Release Options - see section ST6

54mm wide shown



44mm wide & above

38mm wide shown



38mm wide only

▲ Face Fixed screw positions



254mm x 38mm shown with turn T56

▲ Multipoint Configuration - see pages ST5:150-200



254mm x 54mm shown with turn T56, collar K and C01 exposed cylinder option.

▲ US Entry Configuration - see pages ST5:090-140

Backplate - 68 series (round edge design)

A classic Art Deco period Backplate, offered with a selection of collar designs and available either face fixed or concealed fix.

This Backplate is designed to work in conjunction with the Door Levers & Door Knobs to be found in sections ST1 & ST2.



Standard Sizes

| Length | 190 | 254 | 305 | 380 |
|--------|--|-----|-----|-----|
| Width | Availability | | | |
| 27 | Not Available. | | | |
| 32 | | | | |
| 38 | All Face Fix Configurations with type G seating only, <u>except</u> US Entry & Spring Assisted Multipoint. | | | |
| 44 | All Configurations and Options <u>except</u> US Entry. | | | |
| 54 | All Configurations & Options. | | | |
| 64 | | | | |
| 76 | | | | |

Thickness

6mm for all unsprung backplates.
9mm for all spring-assisted* backplates.

*Spring-assisted backplates need to be 9mm thick to accommodate the spring cassette, and require a raised collar; G flush collar/seating option not possible.

Finishes - See our price list or website for finish availability.



6811 190mm x 44mm latch plate shown with collar G

▲ Latch (Passage), Lock & Privacy Configuration - see pages ST5:010-080



▲ Collar, Turn & Privacy Release Options - see section ST6

54mm wide shown



44mm wide & above

38mm wide shown



38mm wide only

▲ Face Fixed screw positions



254mm x 38mm shown with turn T55

▲ Multipoint Configuration - see pages ST5:150-200



254mm x 54mm shown with turn T55, G seat and C01 exposed cylinder option.

▲ US Entry Configuration - see pages ST5:090-140

Backplate - 83 series

A traditional period Backplate, offered with a selection of collar designs and available either face fixed or concealed fix.

This Backplate is designed to work in conjunction with the Door Levers & Door Knobs to be found in sections ST1 & ST2.



Standard Sizes

| Length | 190 | 254 | 305 | 380 |
|--------|-----|-----|-----|-----|
|--------|-----|-----|-----|-----|

| Width | Availability |
|-------|---|
| 27 | Not Available. |
| 32 | Unsprung Multipoint with type G seating only. |
| 38 | All Configurations & Options, <u>except</u> US Entry. |
| 44 | All Configurations & Options. |
| 54 | |
| 64 | |
| 76 | |

Thickness

6mm for all unsprung backplates.
9mm for all spring-assisted* backplates.

*Spring-assisted backplates need to be 9mm thick to accommodate the spring cassette, and require a raised collar; G flush collar/seating option not possible.

Finishes - See our price list or website for finish availability.



8311 190mm x 44mm latch plate shown with collar L

▲ **Latch (Passage), Lock & Privacy Configuration** - see pages ST5:010-080



▲ **Collar, Turn & Privacy Release Options** - see section ST6

54mm wide shown



44mm wide & above

38mm wide shown



38mm wide only

▲ **Face Fixed screw positions**



254mm x 38mm shown with turn T51

▲ **Multipoint Configuration** - see pages ST5:150-200



254mm x 54mm shown with turn T51, collar L and C01 exposed cylinder option.

▲ **US Entry Configuration** - see pages ST5:090-140

Backplate - 84 series

A traditional period Backplate, offered with a selection of collar designs and available either face fixed or concealed fix.

This Backplate is designed to work in conjunction with the Door Levers & Door Knobs to be found in sections ST1 & ST2.



Standard Sizes

| Length | 190 | 254 | 305 | 380 |
|--------|-----|-----|-----|-----|
|--------|-----|-----|-----|-----|

| Width | Availability |
|-------|--|
| 27 | Not Available. |
| 32 | |
| 38 | All Face Fix Configurations with type G seating only, <u>except</u> US Entry & Spring Assisted Multipoint. |
| 44 | All Configurations and Options <u>except</u> US Entry. |
| 54 | All Configurations & Options. |
| 64 | |
| 76 | |

Thickness

6mm for all unsprung backplates.
9mm for all spring-assisted* backplates.

*Spring-assisted backplates need to be 9mm thick to accommodate the spring cassette, and require a raised collar; G flush collar/seating option not possible.

Finishes - See our price list or website for finish availability.



8411 190mm x 44mm latch plate shown with collar L

▲ Latch (Passage), Lock & Privacy Configuration - see pages ST5:010-080



▲ Collar, Turn & Privacy Release Options - see section ST6

54mm wide shown



44mm wide & above

38mm wide shown



38mm wide only

▲ Face Fixed screw positions



254mm x 38mm shown with turn T53

▲ Multipoint Configuration - see pages ST5:150-200



254mm x 54mm shown with turn T53, collar L and C01 exposed cylinder option.

▲ US Entry Configuration - see pages ST5:090-140

Backplate - 86 series

A modern Backplate, offered with a selection of collar designs and available either face fixed or concealed fix.

This Backplate is designed to work in conjunction with the Door Levers & Door Knobs to be found in sections ST1 & ST2.



Standard Sizes

| Length | 190 | 254 | 305 | 380 |
|--------|-----|-----|-----|-----|
|--------|-----|-----|-----|-----|

| Width | Availability |
|-------|--|
| 27 | Not Available. |
| 32 | |
| 38 | All Face Fix Configurations with type G seating only, <u>except</u> US Entry & Spring Assisted Multipoint. |
| 44 | All Configurations and Options <u>except</u> US Entry. |
| 54 | All Configurations & Options. |
| 64 | |
| 76 | |

Thickness

6mm for all unsprung backplates.
9mm for all spring-assisted* backplates.

*Spring-assisted backplates need to be 9mm thick to accommodate the spring cassette, and require a raised collar; G flush collar/seating option not possible.

Finishes - See our price list or website for finish availability.



8611 190mm x 44mm latch plate shown with collar M

▲ Latch (Passage), Lock & Privacy Configuration - see pages ST5:010-080



▲ Collar, Turn & Privacy Release Options - see section ST6

54mm wide shown



44mm wide & above

38mm wide shown



38mm wide only

▲ Face Fixed screw positions



254mm x 38mm shown with turn T67

▲ Multipoint Configuration - see pages ST5:150-200



254mm x 54mm shown with turn T67, collar M and C01 exposed cylinder option.

▲ US Entry Configuration - see pages ST5:090-140

Backplate - 87 series

A classic Regency/Georgian period Backplate, offered with a selection of collar designs and available either face fixed or concealed fix.

This Backplate is designed to work in conjunction with the Door Levers & Door Knobs to be found in sections ST1 & ST2.



Standard Sizes

| Length | 190 | 254 | 305 | 380 |
|--------|-----|-----|-----|-----|
|--------|-----|-----|-----|-----|

| Width | Availability |
|-------|--|
| 27 | Not Available. |
| 32 | |
| 38 | All Face Fix Configurations with type G seating only, <u>except</u> US Entry & Spring Assisted Multipoint. |
| 44 | All Configurations and Options <u>except</u> US Entry. |
| 54 | All Configurations & Options. |
| 64 | |
| 76 | |

Thickness

6mm for all unsprung backplates.
9mm for all spring-assisted* back-plates.

*Spring-assisted backplates need to be 9mm thick to accommodate the spring cassette, and require a raised collar; G flush collar/seating option not possible.

Finishes - See our price list or website for finish availability.



8711 190mm x 44mm latch plate shown with collar K

▲ **Latch (Passage), Lock & Privacy Configuration** - see pages ST5:010-080



▲ **Collar, Turn & Privacy Release Options** - see section ST6

54mm wide shown



54mm wide & above

38mm wide shown



38mm & 44mm wide

▲ **Face Fixed screw positions**



254mm x 38mm shown with turn T53

▲ **Multipoint Configuration** - see pages ST5:150-200



254mm x 54mm shown with turn T53, collar L and C01 exposed cylinder option.

▲ **US Entry Configuration** - see pages ST5:090-140

Backplate - 88 series

A classic Backplate, offered with a selection of collar designs and available either face fixed or concealed fix.

This Backplate is designed to work in conjunction with the Door Levers & Door Knobs to be found in sections ST1 & ST2.



Standard Sizes

| Length | 190 | 254 | 305 | 380 |
|--------|-----|-----|-----|-----|
|--------|-----|-----|-----|-----|

| Width | Availability |
|-------|--|
| 27 | Not Available. |
| 32 | |
| 38 | All Face Fix Configurations with type G seating only, <u>except</u> US Entry & Spring Assisted Multipoint. |
| 44 | All Configurations and Options <u>except</u> US Entry. |
| 54 | All Configurations & Options. |
| 64 | |
| 76 | |

Thickness

6mm for all unsprung backplates.
9mm for all spring-assisted* backplates.

*Spring-assisted backplates need to be 9mm thick to accommodate the spring cassette, and require a raised collar; G flush collar/seating option not possible.

Finishes - See our price list or website for finish availability.



8811 190mm x 44mm latch plate shown with collar L

▲ Latch (Passage), Lock & Privacy Configuration - see pages ST5:010-080



▲ Collar, Turn & Privacy Release Options - see section ST6

54mm wide shown



38mm wide shown



44mm wide & above

38mm wide only

▲ Face Fixed screw positions



254mm x 38mm shown with turn T78

▲ Multipoint Configuration - see pages ST5:150-200



254mm x 54mm shown with turn T78, collar L and C01 exposed cylinder option.

▲ US Entry Configuration - see pages ST5:090-140

Backplate - 93 series

A modern Backplate, offered with a selection of collar designs and available either face fixed or concealed fix.

This Backplate is designed to work in conjunction with the Door Levers & Door Knobs to be found in sections ST1 & ST2.



Standard Sizes

| Length | 190 | 254 | 305 | 380 |
|--------|-----|-----|-----|-----|
|--------|-----|-----|-----|-----|

| Width | Availability |
|-------|--|
| 27 | Not Available. |
| 32 | |
| 38 | All Face Fix Configurations with type G seating only, <u>except</u> US Entry & Spring Assisted Multipoint. |
| 44 | All Configurations and Options <u>except</u> US Entry. |
| 54 | All Configurations & Options. |
| 64 | |
| 76 | |

Thickness

6mm for all unsprung backplates.
9mm for all spring-assisted* backplates.

*Spring-assisted backplates need to be 9mm thick to accommodate the spring cassette, and require a raised collar; G flush collar/seating option not possible.

Finishes - See our price list or website for finish availability.



9311 190mm x 54mm latch plate shown with collar G

▲ **Latch (Passage), Lock & Privacy Configuration** - see pages ST5:010-080

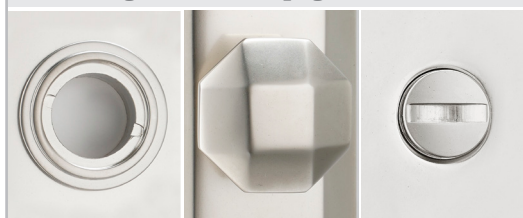

▲ **Collar, Turn & Privacy Release Options** - see section ST6

54mm wide shown

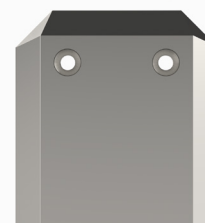

44mm wide & above

38mm wide shown



38mm wide only

▲ **Face Fixed screw positions**

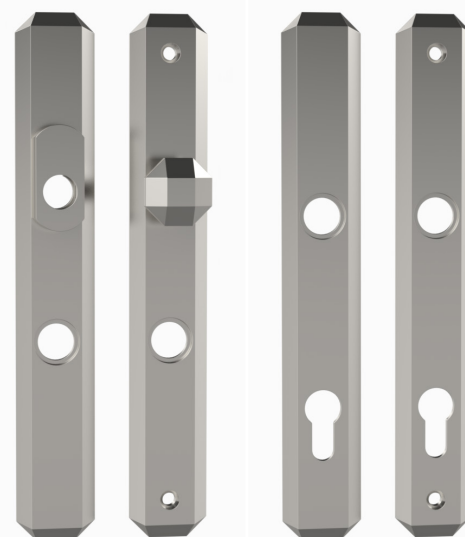

254mm x 38mm shown with turn T84

▲ **Multipoint Configuration** - see pages ST5:150-200

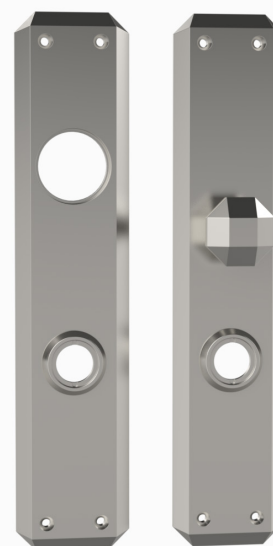

254mm x 54mm shown with turn T84, collar F and C01 exposed cylinder option.

▲ **US Entry Configuration** - see pages ST5:090-140